



GRIP Head office (Jinsung Eurotec co., ltd.)

#817 Daerung technotown 12nd Gasandigital 2 ro 14 Geumcheon-gu Seoul Republic of korea.

GRIP Factory

#b101-201 397 Seckcheon-ro Buchun-si Gyeonggi-do Republic of Korea

Tel.+82 32 624 0907~8

Fax.+82 32 624 0909

gripperfect@gmail.com

www.gripkorea.com



HYDRO-ZERO FIT

Zero run-out setting for optimum machining.

New!!

More Various product line-up



HYDRO-ZERO FIT

Standard Run-Out 3xd 3Micron.

Standard run-out 3 μm .
ID25/ ID32 run-out 5 μm .

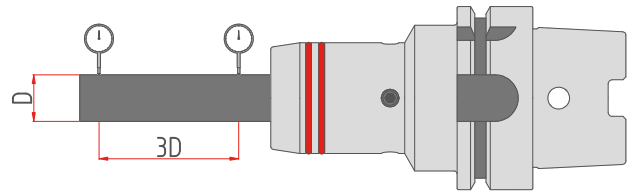

ZERO Run-Out setting.

4pcs screws in 90 degree direction
for Run-out setting for more precise work.

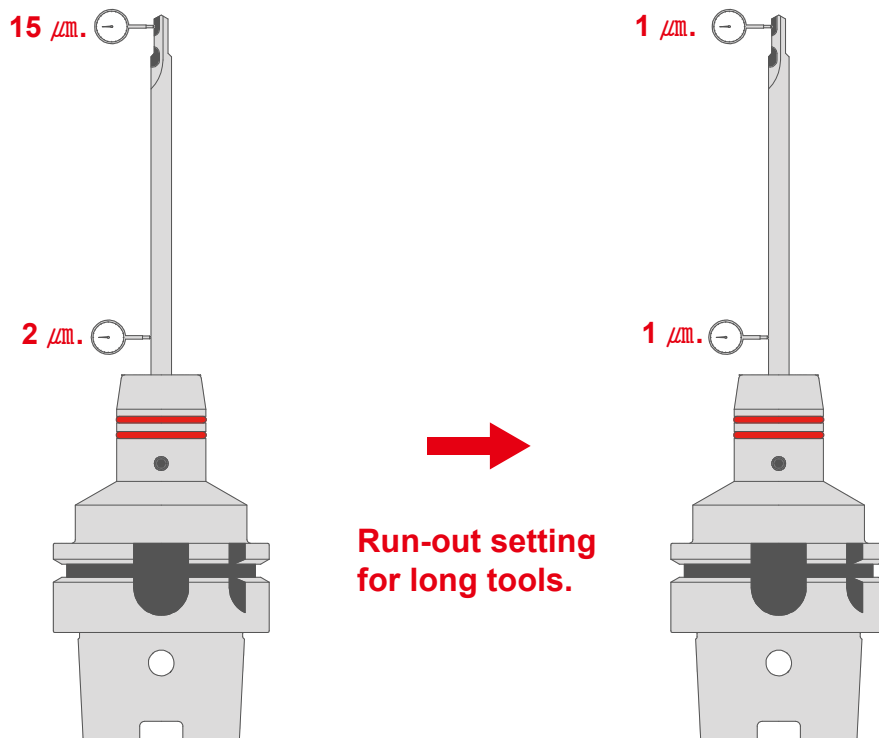
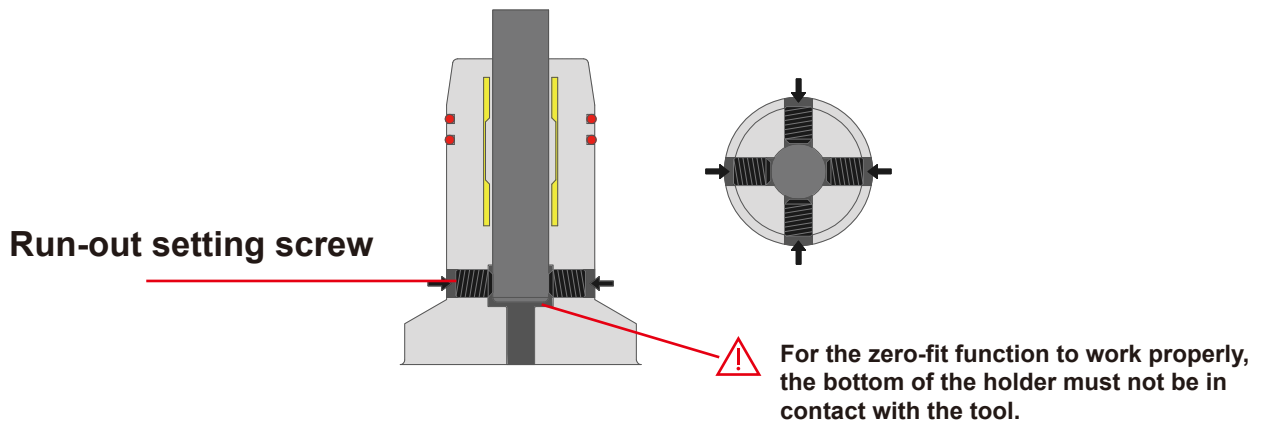



ZERO Run-Out
setting video.



4pcs screws in 90 degree direction
for Run-out setting.

Clamping screw

How to use

- 1step- Insert tool.
- 2step- Lock the clamping screw.
- 3step- Run-out check.
- 4step- Zero setting with 4-way run-out setting screw.

Dimensions(mm)

HSK-A63		D1	D2	D3	D4	L1	L2	L3	L4	Clamping wrench	Adjustment bolt (wrench)	Kg.
HSK-A63/GZF6/90	●	6	23	26	50	90	41	31	44	TR-4.0	M5x0.8(T-2.5)	1.2
HSK-A63/GZF8/90	●	8	25	28	50	90	41	31	44	TR-4.0	M6x1.0(T-3.0)	1.2
HSK-A63/GZF10/95	●	10	27	30	50	95	48	38	50	TR-4.0	M8x1.0(T-4.0)	1.3
HSK-A63/GZF12/100	●	12	29	32	50	100	53	43	55	TR-4.0	M10x1.0(T-5.0)	1.3
HSK-A63/GZF16/105	●	16	35	38	50	105	58	48	61	TR-4.0	M12x1.0(T-6.0)	1.4
HSK-A63/GZF20/105	●	20	39	42	50	105	58	48	63	TR-5.0	M16x1.0(T-6.0)	1.5
HSK-A63/GZF25/115	●	25	46	50	-	115	66	56	89	TR-5.0	M16x1.0(T-6.0)	2.6
HSK-A63/GZF32/130	●	32	56	60	52.5	130	70	60	104	TR-5.0	M16x1.0(T-6.0)	3.2

Availability: ● Stock ▲ Short lead time ○ Made to order

- »h6 shank tools must be used.
- »Tool length can be adjusted up to 10mm.
(If you use the ZERO-FIT function, you cannot use the adjust screw.)
- »T-wrench is must be ordered separately.
(GRIP torque wrench is recommended.)
- »If you use the ZERO-FIT function, you cannot use the hydro-sleeve.
- »Data carrier and Coolant tube as an option.
- »All products center through coolant system.
- »Additional sizes and special designs available on request.
- ⚠ The minimum tool depth must be observed.

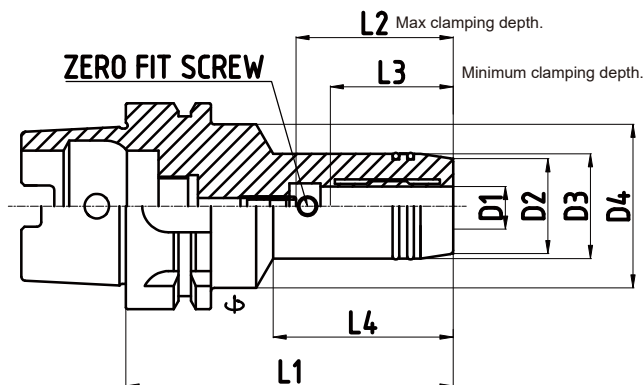

HSK63A

≡ Dimensions(mm)

HSK-A100		D1	D2	D3	D4	L1	L2	L3	L4	Clamping wrench	Adjustment bolt (wrench)	Kg.
HSK-A100/GZF6/95	○	6	23	26	50	95	41	31	46	TR-4.0	M5x0.8(T-2.5)	2.8
HSK-A100/GZF8/95	○	8	25	28	50	95	41	31	46	TR-4.0	M6x1.0(T-3.0)	2.8
HSK-A100/GZF10/100	○	10	27	30	50	100	48	38	52	TR-4.0	M8x1.0(T-4.0)	2.9
HSK-A100/GZF12/105	●	12	29	32	50	105	53	43	57	TR-4.0	M10x1.0(T-5.0)	3.0
HSK-A100/GZF16/110	○	16	35	38	50	110	58	48	63	TR-4.0	M12x1.0(T-6.0)	3.1
HSK-A100/GZF20/110	●	20	39	42	50	110	58	48	64	TR-5.0	M16x1.0(T-6.0)	3.4
HSK-A100/GZF25/120	○	25	53	57	63	120	67	57	72	TR-5.0	M16x1.0(T-6.0)	3.8
HSK-A100/GZF32/120	○	32	58	63	75	120	71	61	72	TR-5.0	M16x1.0(T-6.0)	4.2

Availability: ● Stock ▲ Short lead time ○ Made to order

- »h6 shank tools must be used.
- »Tool length can be adjusted up to 10mm.
(If you use the ZERO-FIT function, you cannot use the adjust screw.)
- »T-wrench is must be ordered separately.
(GRIP torque wrench is recommended.)
- »If you use the ZERO-FIT function, you cannot use the hydro-sleeve.
- »Data carrier and Coolant tube as an option.
- »All products center through coolant system.
- »Additional sizes and special designs available on request.
- ⚠ The minimum tool depth must be observed.

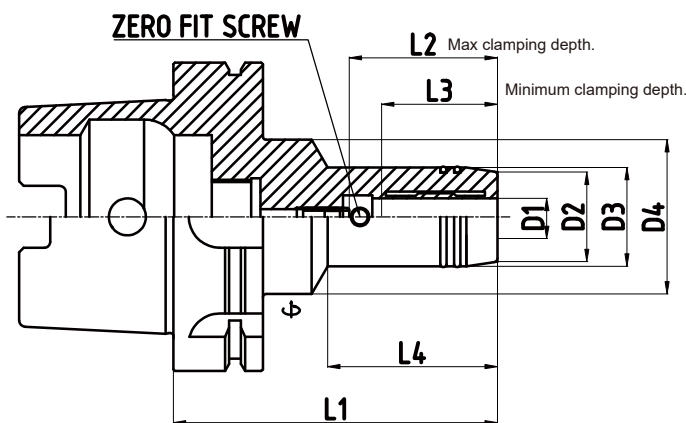

HSK100A

Dimensions(mm)

BT30		D1	D2	D3	D4	L1	L2	L3	L4	Clamping wrench	Adjustment bolt (wrench)	Kg.
BT30/GZF6/90	●	6	23	26	44.5	90	41	31	48	TR-4.0	M5x0.8(T-2.5)	0.8
BT30/GZF8/90	●	8	25	28	44.5	90	41	31	48	TR-4.0	M6x1.0(T-3.0)	0.8
BT30/GZF10/90	●	10	27	30	44.5	90	48	38	51	TR-4.0	M8x1.0(T-4.0)	0.8
BT30/GZF12/95	●	12	29	32	44.5	95	53	43	56	TR-4.0	M10x1.0(T-5.0)	0.9
BT30/GZF16/100	●	16	35	38	44.5	100	58	48	58	TR-4.0	M12x1.0(T-6.0)	1.1
BT30/GZF20/105	●	20	39	42	44.5	105	58	48	63	TR-4.0	M12x1.0(T-6.0)	1.2

Availability: ● Stock ▲ Short lead time ○ Made to order

- »h6 shank tools must be used.
 - »Tool length can be adjusted up to 10mm.
(If you use the ZERO-FIT function, you cannot use the adjust screw.)
 - »T-wrench is must be ordered separately.
(GRIP torque wrench is recommended.)
 - »If you use the ZERO-FIT function, you cannot use the hydro-sleeve.
 - »All products center through coolant system.
 - »Additional sizes and special designs available on request.
- ⚠ The minimum tool depth must be observed.

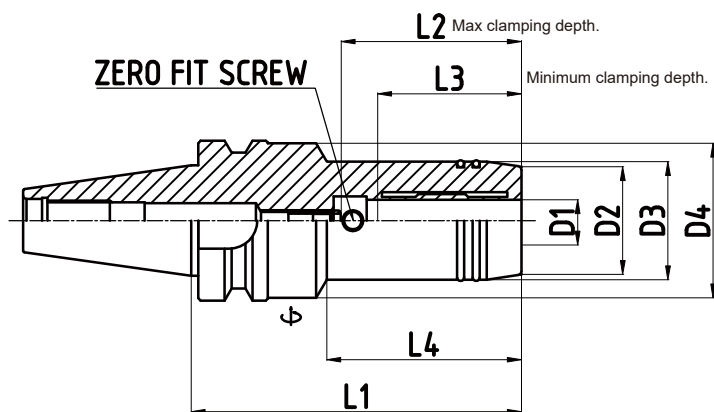

BT30

Dimensions(mm)

BT40		D1	D2	D3	D4	L1	L2	L3	L4	Clamping wrench	Adjustment bolt (wrench)	Kg.
BT40/GZF6/90	●	6	23	26	50	90	41	31	44	TR-4.0	M5x0.8(T-2.5)	1.4
BT40/GZF8/90	●	8	25	28	50	90	41	31	44	TR-4.0	M6x1.0(T-3.0)	1.4
BT40/GZF10/95	●	10	27	30	50	95	48	38	49	TR-4.0	M8x1.0(T-4.0)	1.5
BT40/GZF12/100	●	12	29	32	50	100	53	43	54	TR-4.0	M10x1.0(T-5.0)	1.6
BT40/GZF16/105	●	16	35	38	50	105	58	48	63	TR-4.0	M12x1.0(T-6.0)	1.7
BT40/GZF20/105	●	20	39	42	50	105	58	48	63	TR-5.0	M16x1.0(T-6.0)	1.8
BT40/GZF25/110	●	25	53	57	57	110	67	57	-	TR-5.0	M16x1.0(T-6.0)	2.3
BT40/GZF32/115	●	32	58	62	62	115	71	61	-	TR-5.0	M16x1.0(T-6.0)	2.6

Availability: ● Stock ▲ Short lead time ○ Made to order

- »h6 shank tools must be used.
 - »Tool length can be adjusted up to 10mm.
(If you use the ZERO-FIT function, you cannot use the adjust screw.)
 - »T-wrench is must be ordered separately.
(GRIP torque wrench is recommended.)
 - »If you use the ZERO-FIT function, you cannot use the hydro-sleeve.
 - »All products center through coolant system.
 - »Additional sizes and special designs available on request.
- ⚠ The minimum tool depth must be observed.

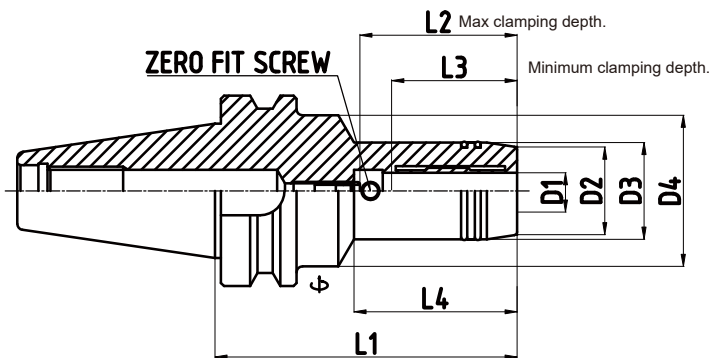

BT40

Dimensions(mm)

BT50		D1	D2	D3	D4	L1	L2	L3	L4	Clamping wrench	Adjustment bolt (wrench)	Kg.
BT50/GZF6/105	▲	6	23	26	50	105	41	31	47	TR-4.0	M5x0.8(T-2.5)	4.2
BT50/GZF8/105	○	8	25	28	50	105	41	31	47	TR-4.0	M6x1.0(T-3.0)	4.2
BT50/GZF10/110	○	10	27	30	50	110	48	38	52	TR-4.0	M8x1.0(T-4.0)	4.3
BT50/GZF12/115	●	12	29	32	50	115	53	43	57	TR-4.0	M10x1.0(T-5.0)	4.3
BT50/GZF16/120	○	16	35	38	50	120	58	48	62	TR-4.0	M12x1.0(T-6.0)	4.5
BT50/GZF20/120	●	20	39	42	50	120	58	48	62	TR-5.0	M16x1.0(T-6.0)	4.6
BT50/GZF25/125	○	25	53	57	57	125	67	57	-	TR-5.0	M16x1.0(T-6.0)	5.2
BT50/GZF32/125	▲	32	58	62	62	125	71	61	-	TR-5.0	M16x1.0(T-6.0)	5.4

Availability: ● Stock ▲ Short lead time ○ Made to order

- »h6 shank tools must be used.
- »Tool length can be adjusted up to 10mm.
(If you use the ZERO-FIT function, you cannot use the adjust screw.)
- »T-wrench is must be ordered separately.
(GRIP torque wrench is recommended.)
- »If you use the ZERO-FIT function, you cannot use the hydro-sleeve.
- »All products center through coolant system.
- »Additional sizes and special designs available on request.

⚠ The minimum tool depth must be observed.

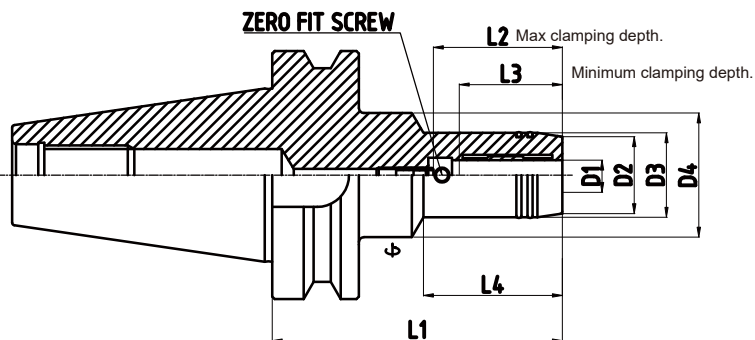

Dimensions(mm)

SK40		D1	D2	D3	D4	L1	L2	L3	L4	Clamping wrench	Adjustment bolt (wrench)	Kg.
SK40/GZF12/90	○	12	29	32	50	90	53	43	53	TR-4.0	M10x1.0(T-5.0)	1.4
SK40/GZF20/90	○	20	39	42	50	90	58	48	58	TR-4.0	M16x1.0(T-6.0)	1.5

SK50		D1	D2	D3	D4	L1	L2	L3	L4	Clamping wrench	Adjustment bolt (wrench)	Kg.
SK50/GZF12/90	○	12	29	32	50	90	53	43	53	TR-4.0	M10x1.0(T-5.0)	3.4
SK50/GZF20/110	○	20	39	42	50	110	58	48	68	TR-5.0	M16x1.0(T-6.0)	3.6
SK50/GZF32/115	○	32	58	62	62	115	71	61	-	TR-5.0	M16x1.0(T-6.0)	4.9

Availability: ● Stock ▲ Short lead time ○ Made to order

- »h6 shank tools must be used.
 - »Tool length can be adjusted up to 10mm.
(If you use the ZERO-FIT function, you cannot use the adjust screw.)
 - »T-wrench is must be ordered separately.
(GRIP torque wrench is recommended.)
 - »If you use the ZERO-FIT function, you cannot use the hydro-sleeve.
 - »All products center through coolant system.
 - »Additional sizes and special designs available on request.
- ⚠ The minimum tool depth must be observed.

